



DSA 2023 PREFERRED BUILDER REBATES



Alexandria



Aberdeen



Keowee



Milan



Wakefield



Tuscany

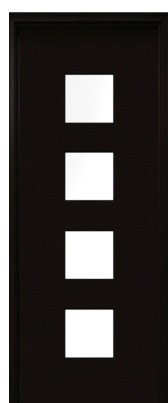

Modena



Tiffany

Preferred DSA Builders receive:

- **\$25 rebate** for each DSA Door
- **50% OFF** Display Doors

APPLY NOW to become a Preferred DSA Builder!

2023 PREFERRED BUILDER REBATE PROGRAM DETAILS:

DSA will provide a Preferred Builder Rebate of \$25.00 per door on purchases of Standard or Custom Doors. In order to qualify for our Preferred Builder Program, Builders need to display a DSA Door in their showroom or model home. Selected displays are available at 50% off with free factory pre-finishing. Preferred Builder must be exclusive with DSA for wood door entry systems.

To qualify for Rebates, Preferred Builder purchases must be specified by Purchasing Dealer at time of purchase, and Builder must request Rebate within 90 days of purchase. Applications and Claim forms must be sent with completed W9 and ACH instructions to DSAAP@DSADoors.com.

 **DSA**
Master Crafted Doors

10681 World Trade Blvd, Raleigh NC
(919) 781-3200 • www.DSADoors.com



DSA 2023 PREFERRED BUILDER REBATE PROGRAM Application & Claim Form

2023 PREFERRED BUILDER REBATE PROGRAM DETAILS:

DSA will provide a Preferred Builder Rebate of \$25.00 per door on purchases of Standard or Custom Doors. In order to qualify for our Preferred Builder Program, Builders need to display a DSA Door in their showroom or model home. Selected displays are available at 50% off with free factory pre-finishing. Preferred Builder must be exclusive with DSA for wood door entry systems.

To qualify for Rebates, Preferred Builder purchases must be specified by Purchasing Dealer at time of purchase, and Builder must request Rebate within 120 days of purchase. Applications and Claim forms must be sent with completed W9 and ACH instructions to DSAAP@DSADoors.com.

PREFERRED DEALER STATUS:

☐

New

☐

Existing

PREFERRED BUILDER NAME:			
REBATE RECIPIENT NAME:			
RECIPIENT ADDRESS:	CITY:	STATE:	ZIP:
PHONE:	EMAIL:		
DEVELOPMENT NAME:			# UNITS:
DEVELOPMENT ADDRESS:			
AUTHORIZED SIGNATURE: 			
PURCHASING DEALER NAME:		COMPLETED W9 & ACH INSTRUCTIONS INCLUDED: <input type="checkbox"/>	



DSA 2023 PREFERRED BUILDER REBATE PROGRAM Display Order Form

In order to qualify for our Preferred Builder Program, Builders must display a DSA Door in their showroom or model home. Selected Display Doors are available at 50% off with free factory pre-finishing.

Standard and Wynstellar Display Doors are eligible for 50% off. Our Custom, Bifold, Pivot and Port doors are also eligible for a Display discount, but must be quoted by a dedicated DSA Representative.

** Standard pricing applies*

		DATE:	
PO#:		ORDER #:	
LEAD TIME:		UNIT PRICE:	
BUILDER NAME:		BUILDER CONTACT NAME:	
SHIPPING ADDRESS:		CITY	STATE ZIP
BUILDER REPRESENTATIVE NAME:	EMAIL:	PHONE:	
DISPLAY LOCATION: <input type="checkbox"/> Showroom <input type="checkbox"/> Model Home		# DEVELOPMENT UNITS:	
DISPLAY ADDRESS:		CITY	STATE ZIP
DOOR STYLE:			
CONFIGURATION:		UNIT SIZE:	
WOOD SPECIES:		GLASS/IRON TYPE:	
SIDE LITE:		TRANSOM:	
BORE: <input type="checkbox"/> None <input type="checkbox"/> Double Bore <input type="checkbox"/> Single Bore		HARDWARE*:	
BRICKMOULD: <input type="checkbox"/> 180 (2") <input type="checkbox"/> S4S (3 1/2") <input type="checkbox"/> Other*:		BACKSET:	
SILL/HINGE FINISH: <input type="checkbox"/> Oil Rubbed Bronze <input type="checkbox"/> Nickel/Stainless Steel		JAMB SIZE: <input type="checkbox"/> 4 9/16" <input type="checkbox"/> 6 9/16"	
PRE-FINISH: <input type="checkbox"/> Russet <input type="checkbox"/> Chestnut <input type="checkbox"/> Coco <input type="checkbox"/> Cinnamon <input type="checkbox"/> Ebony (<i>Accoya only</i>)			



STANDARD PRE-HUNG QUOTE / ORDER FORM

10681 World Trade Blvd Raleigh, NC 27617 • (919) 781-3200
Sales@DSADoors.com • www.DSADoors.com

PO#:

DATE:

COMPANY NAME:

JOB NAME:

SHIPPING ADDRESS:

DEALER COST:

CITY:

STATE:

ZIP:

EMAIL:

CONTACT NAME:

PHONE #:

UNIT SPECIFICATIONS

\$ denotes additional cost associated with options

WOOD SPECIES:

- ☐ Mahogany
☐ Knotty Alder
☐ Accoya

COASTAL RATING:

- ☐ Not Rated
☐ DP-50 Rated\$

DOOR SIZE:*





- ☐ Rough Opening
☐ Frame Size

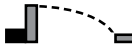

* Specific sizes may become Custom

DOOR SWING

Swing is determined from exterior of home looking in

- ☐ LH Inswing  ☐ RH Inswing 
☐ LH Outswing  ☐ RH Outswing 

DOOR NAME:

____ LT

JAMB SIZE:

- ☐ 4 1/16" ☐ 6 1/16" ☐ Other\$ _____

CONFIGURATION:

- ☐ Square
☐ Arch

SIDE LITE(S):

QTY: ☐ 1 ☐ 2

TRANSOM:

ACTIVE BORE:

- ☐ Double Bore ☐ Single Bore ☐ No Bore

BACKSET:

- ☐ 2 3/8" ☐ 2 3/4" ☐ Custom Mortise\$

GLASS/IRON:

INACTIVE BORE:

- ☐ Double Bore ☐ Single Bore ☐ No Bore

BRICKMOULD:

- ☐ 180 (2") ☐ S4S (3 1/2") ☐ Other\$ _____ ☐ Applied ☐ Unapplied

THRESHOLD FINISH:

- ☐ Bronze ☐ Brushed Nickel

CONCEALED HINGES\$:

- ☐ Yes ☐ No

HINGE FINISH:

- ☐ Oil Rubbed Bronze ☐ Satin Nickel

OPTIONAL ITEMS\$

\$ denotes additional cost associated with options

MULTIPOINT LOCKS:

HARDWARE FINISH:

- ☐ Black ☐ Satin Nickel

- ☐ Ashland Multipoint (Active) ☐ Ashland Multipoint (Passive)

- ☐ GU 3-Point Lock (Active) *for EMTEK#4 lever handles

LEVER QTY: ☐ Active ☐ Active & Dummy/Passive ☐ No Lever Handles

LEVER STYLE: ☐ 1) Arched ☐ 2) Square ☐ 3) Contemporary

NON-MULTIPOINT HANDLES:

HARDWARE FINISH:

- ☐ Black

- ☐ Emtek Thumbatch Entry Set

- ☐ Satin Nickel

EMPowered Smart Lock*: ☐ Yes ☐ No

STYLE: ☐ Square (Keyed) ☐ Square (Digital) ☐ Full Plate

INTERIOR HANDLE: ☐ Lever ☐ Knob

- ☐ GU 3-Point Lock with Thumbatch

- ☐ Interior Lever ☐ Interior Knob

DANALOCK V3 SMART LOCK:

- ☐ *Yes ☐ No

- ☐ Include Danapad V3*

- ☐ GU 3-Point Lock with Belcanto Lever & Danalock V3

- ☐ Include Danapad V3

OTHER LOCK OPTIONS:

PREFINISHING: *denotes colors available for Accoya Wynstellar doors

- ☐ Russet ☐ Chestnut ☐ Distressed Russet
☐ Cinnamon Bark* ☐ Coco ☐ Distressed Chestnut
☐ Ebony* (Accoya only)

INTERIOR CASING:

(interior casing is always shipped loose)

NOTES & REQUESTS

SPECIAL INSTRUCTIONS, HARDWARE REQUESTS, & ACCESSORIES:

☐ Yes, the builder and I have confirmed jamb size.

SPIFF INFORMATION

☐ Check to opt out

If your order qualifies for our SPIFF program, information MUST be filled out and sent in when order is placed in order to redeem. DSA cannot process SPIFFs sent separately from the order. Revised SPIFFs cannot be accepted, no exceptions. You are responsible for reporting SPIFF income for tax purposes. To enroll in and learn more about our SPIFF program, fill out and return our SPIFF Enrollment Form at www.DSADoors.com/SPIFF.

RECIPIENT NAME: _____

RECIPIENT EMAIL: _____

SPIFF AMOUNT

\$.00

SIGNATURE

DATE

BUILDER REBATE INFORMATION

DSA provides a Rebate of \$25.00 per Pre-Hung Door Unit to our Preferred Builders. To qualify for Rebates, Builder must be approved in our Preferred Builder Program, and purchases must be specified by the Purchasing Dealers at the time of order. Builder Applications and Claim forms must be sent with completed W9 and ACH instructions to DSAAP@DSADoors.com.

BUILDER NAME: _____

BUILDER EMAIL: _____

DEVELOPMENT NAME: _____

LOT / UNIT #: _____

REBATE AMOUNT

\$.00

SIGNATURE

DATE



CUSTOM QUOTE / ORDER REQUEST FORM

10681 World Trade Blvd Raleigh, NC 27617 • (919) 781-3200
Custom@DSADoors.com • www.DSADoors.com

PO #:

JOB NAME:

COMPANY NAME:

DATE:

SHIPPING ADDRESS:

CONTACT NAME:





CITY:

STATE:

ZIP:

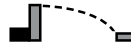
PHONE #:

UNIT SPECIFICATIONS

UNIT SIZE:	CONFIGURATION:		DOOR SWING
	RATING: <input type="checkbox"/> Non-rated <input type="checkbox"/> DP-50 <input type="checkbox"/> Impact		<input type="checkbox"/> LH Inswing  <input type="checkbox"/> RH Inswing 
MEASUREMENTS: <input type="checkbox"/> Rough opening <input type="checkbox"/> Frame size <input type="checkbox"/> Outside brickmould			<input type="checkbox"/> LH Outswing  <input type="checkbox"/> RH Outswing 
WOOD SPECIES:	THICKNESS: <input type="checkbox"/> 1 3/4" <input type="checkbox"/> 2 1/4"	JAMB SIZE: <input type="checkbox"/> 4 9/16" <input type="checkbox"/> 6 9/16" <input type="checkbox"/> Other: _____	
DOOR STYLE:	ACTIVE BORE: <input type="checkbox"/> Double Bore <input type="checkbox"/> Single Bore <input type="checkbox"/> None		
SIDE LITE(S):	QTY:	BACKSET: <input type="checkbox"/> 2 3/8" <input type="checkbox"/> 2 3/4" <input type="checkbox"/> Custom Mortise	
TRANSOM:	QTY:	INACTIVE BORE: <input type="checkbox"/> Double Bore <input type="checkbox"/> Single Bore <input type="checkbox"/> None	
BRICKMOULD STYLE:	BRICKMOULD: <input type="checkbox"/> Applied <input type="checkbox"/> Unapplied	THRESHOLD FINISH: <input type="checkbox"/> Bronze <input type="checkbox"/> Brushed Nickel	
GLASS OPTION:	IRON OPTION: <input type="checkbox"/> Yes <input type="checkbox"/> No	HINGE FINISH: <input type="checkbox"/> Oil Rubbed Bronze <input type="checkbox"/> Satin Nickel	

OPTIONAL ITEMS^{\$}

^{\$} denotes additional cost associated with options

MULTIPOINT LOCKS:	HARDWARE FINISH: <input type="checkbox"/> Black <input type="checkbox"/> Satin Nickel	NON-MULTIPOINT HANDLES:	HARDWARE FINISH: <input type="checkbox"/> Black <input type="checkbox"/> Satin Nickel
<input type="checkbox"/> Ashland Multipoint (Active) <input type="checkbox"/> Ashland Multipoint (Passive)		<input type="checkbox"/> Emtek Thumbblatch Entry Set	
<input type="checkbox"/> GU 3-Point Lock (Active) *for EMTEK#4 lever handles		EMPowered Smart Lock*: <input type="checkbox"/> Yes <input type="checkbox"/> No	
LEVER QTY: <input type="checkbox"/> Active <input type="checkbox"/> Active & Dummy/Passive <input type="checkbox"/> No Lever Handles		STYLE: <input type="checkbox"/> Square (Keyed) <input type="checkbox"/> Square (Digital) <input type="checkbox"/> Full Plate	
LEVER STYLE: <input type="checkbox"/> 1) Arched <input type="checkbox"/> 2) Square <input type="checkbox"/> 3) Contemporary		INTERIOR HANDLE: <input type="checkbox"/> Lever <input type="checkbox"/> Knob	
<input type="checkbox"/> GU 3-Point Lock with Thumbblatch <input type="checkbox"/> Interior Lever <input type="checkbox"/> Interior Knob	<input type="checkbox"/> GU 3-Point Lock with Belcanto Lever & Danalock V3 <input type="checkbox"/> Include Danapad V3	PREFINISHING: *denotes colors available for Accoya Wynstellar doors	
DANALOCK V3 SMART LOCK: <input type="checkbox"/> *Yes <input type="checkbox"/> No <input type="checkbox"/> Include Danapad V3*	OTHER LOCK OPTIONS:	<input type="checkbox"/> Russet <input type="checkbox"/> Chestnut <input type="checkbox"/> Distressed Russet <input type="checkbox"/> Cinnamon Bark* <input type="checkbox"/> Coco <input type="checkbox"/> Distressed Chestnut <input type="checkbox"/> Ebony* (Accoya only)	
		INTERIOR CASING: (interior casing is always shipped loose)	

NOTES & REQUESTS

SPECIAL INSTRUCTIONS:

SPIFF INFORMATION

☐ Check to opt out

If your order qualifies for our SPIFF program, information MUST be filled out and sent in when order is placed in order to redeem. DSA cannot process SPIFFs sent separately from the order. Revised SPIFFs cannot be accepted, no exceptions. You are responsible for reporting SPIFF income for tax purposes. To enroll in and learn more about our SPIFF program, fill out and return our SPIFF Enrollment Form at www.DSADoors.com/SPIFF.

RECIPIENT NAME: _____

SPIFF AMOUNT

RECIPIENT EMAIL: _____

\$.00

SIGNATURE

DATE

BUILDER REBATE INFORMATION

DSA provides a Rebate of \$25.00 per Pre-Hung Door Unit to our Preferred Builders. To qualify for Rebates, Builder must be approved in our Preferred Builder Program, and purchases must be specified by the Purchasing Dealers at the time of order. Builder Applications and Claim forms must be sent with completed W9 and ACH instructions to DSAAP@DSADoors.com.

BUILDER NAME: _____

BUILDER EMAIL: _____

DEVELOPMENT NAME: _____

LOT / UNIT #: _____

REBATE AMOUNT

\$.00

SIGNATURE

DATE



PORT COLLECTION QUOTE / ORDER FORM

10681 World Trade Blvd Raleigh, NC 27617 • (919) 781-3200
Sales@DSADoors.com • www.DSADoors.com

PO#:

DATE:

COMPANY NAME:

JOB NAME:

SHIPPING ADDRESS:

DEALER COST:

CITY:

STATE:

ZIP:

EMAIL:

CONTACT NAME:

PHONE #:

UNIT SPECIFICATIONS

\$ denotes additional cost associated with options

WOOD SPECIES: <input checked="" type="checkbox"/> Mahogany	COASTAL RATING: <input checked="" type="checkbox"/> HVHZ Impact	DOOR NAME: LITES:	DOOR SIZE: <input type="checkbox"/> 3'0" x 6'8" (Single) <input type="checkbox"/> 6'0" x 6'8" (Double) <input type="checkbox"/> 3'0" x 8'0" (Single) <input type="checkbox"/> 6'0" x 8'0" (Double)
DOOR THICKNESS: <input checked="" type="checkbox"/> 2-1/4"	CONFIGURATION:	GLASS: <input type="checkbox"/> Clear Laminated Impact IG Low E <input type="checkbox"/> Other \$ _____	DOOR SWING: <i>Swing is determined from exterior of home looking in</i> <input type="checkbox"/> LH Inswing <input type="checkbox"/> RH Inswing <input type="checkbox"/> LH Outswing <input type="checkbox"/> RH Outswing \$
MULTIPOINT LOCKING SYSTEM: <input checked="" type="checkbox"/> Ashland <small>Double Doors require the Active & Passive Lock Mechanism.</small>		SILL FINISH: <input type="checkbox"/> Bronze <input type="checkbox"/> *Brushed Nickel <small>*Brushed Nickel finish only available for Outswing units</small>	BRICKMOULD: <input type="checkbox"/> 180 (2") <input type="checkbox"/> S4S (3 1/2") <input type="checkbox"/> Other \$ <input type="checkbox"/> Applied <input type="checkbox"/> Unapplied
JAMB SIZE: <input type="checkbox"/> 4 5/16" <input type="checkbox"/> 6 5/16" <input type="checkbox"/> Other \$ _____		HINGE FINISH: <input type="checkbox"/> Bronze <input type="checkbox"/> Satin Nickel	

OPTIONAL ITEMS

\$ denotes additional cost associated with options

EMTEK LEVER HANDLESET OPTIONS: LEVER FINISH: <input type="checkbox"/> Black <input type="checkbox"/> Satin Nickel LEVER OPTIONS: <input type="checkbox"/> Active <input type="checkbox"/> Active & Passive <input type="checkbox"/> N/A LEVER HANDLESET STYLE: <input type="checkbox"/> Arched(1) <input type="checkbox"/> Square(2) <input type="checkbox"/> Contemporary(3)	PREFINISHING: <input type="checkbox"/> Russet <input type="checkbox"/> Chestnut <input type="checkbox"/> Coco <input type="checkbox"/> Cinnamon Bark INTERIOR CASING: <small>(interior casing is always shipped loose)</small> <input type="checkbox"/> 445 <input type="checkbox"/> 470 <input type="checkbox"/> RB3 <input type="checkbox"/> S4S <input type="checkbox"/> Other _____
--	---

NOTES & REQUESTS

SPECIAL INSTRUCTIONS, HARDWARE REQUESTS, & ACCESSORIES:

DSA'S PORT COLLECTION DEALER NOTES:

- Please be sure to explain any "Other" designations in the box to the left.
- Keep in mind that deviations from our standard Port Collection offerings may result in increased lead time and may be transferred to Custom department.
- Max 2" trim on stock height only.
- Jamb extensions are available for Inswing and Outswing doors. Inswing ranges from 4 5/16" to 8 1/4", and outswing ranges from 4 5/16" to 5 1/2". Upcharge applies.
- Contact your DSA Representative or email Sales@DSADoors.com for more information on Port Collection orders.

☐ Yes, the builder and I have confirmed jamb size.

SPIFF INFORMATION

☐ Check to opt out

If your order qualifies for our SPIFF program, information MUST be filled out and sent in when order is placed in order to redeem. DSA cannot process SPIFFs sent separately from the order. Revised SPIFFs cannot be accepted, no exceptions. You are responsible for reporting SPIFF income for tax purposes. To enroll in and learn more about our SPIFF program, fill out and return our SPIFF Enrollment Form at www.DSADoors.com/SPIFF.

RECIPIENT NAME: _____

RECIPIENT EMAIL: _____

SPIFF AMOUNT

\$.00

SIGNATURE

DATE

BUILDER REBATE INFORMATION

DSA provides a Rebate of \$25.00 per Pre-Hung Door Unit to our Preferred Builders. To qualify for Rebates, Builder must be approved in our Preferred Builder Program, and purchases must be specified by the Purchasing Dealers at the time of order. Builder Applications and Claim forms must be sent with completed W9 and ACH instructions to DSAAP@DSADoors.com.

BUILDER NAME: _____

BUILDER EMAIL: _____

DEVELOPMENT NAME: _____

LOT / UNIT #: _____

REBATE AMOUNT

\$.00

SIGNATURE

DATE

COMPANY NAME:

CONTACT NAME::

SHIPPING ADDRESS:

PHONE:

CITY:

STATE:

ZIP:

TOTAL \$:

SELECT CONFIGURATION:



Denotes external access door



W-9: 3L Opening



W-9: 3R Opening



W-12: 3L+1R Opening

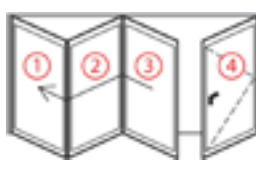
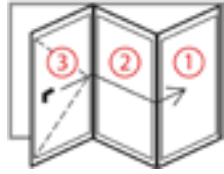
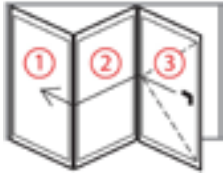

W-12: 1L+3R Opening



W-16: 5L Opening



W-16: 5R Opening

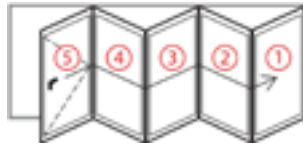
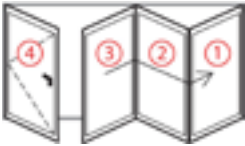

Wood Species: Engineered Accoya®

Door Thickness: 2 1/4"

Swing: Outswing only

Glass: 1" thick Clear IG Low E

Threshold: Bronze Anodized Aluminium

***Active Locking System:** GU® 4-Point Lock

Brickmould & Interior Casing: N/A

Coastal Rating: DP-50

** Active Lock is included with all Bifold Doors. Double Bore and other Multipoint Locking Systems are not available.*

W-9 Frame Size: 106 3/4" x 98 3/4"

W-9 Rough Opening: 108 1/4" x 99 1/2"

W-12 Frame Size: 141 3/8" x 98 3/4"

W-12 Rough Opening: 142 7/8" x 99 1/2"

W-16 Frame Size: 187 1/2" x 98 3/4"

W-16 Rough Opening: 189" x 99 1/2"

PREFINISH (Standard Options)



Ebony



Unfinished*



Cinnamon Bark

JAMB SIZE (Stain Grade Accoya)



5-7/8"



6-9/16"

** Custom jamb sizes are not available standard. Jamb extensions can be custom ordered at an additional cost and extended lead time. No jambs smaller than 5-7/8".*

ALLEGRO LEVER SET (Active Handle only)



Black



N/A



Satin Nickel

BIFOLD HARDWARE FINISH (Stainless Steel)



Black



Stainless Steel

NOTES & SPECIAL INSTRUCTIONS

**Accoya's acetylation process can result in a discoloration on the surface of the wood, which fades with UV exposure or is easily covered by opaque stain. Light stain colors are not recommended for Accoya.*

SHIPPING PREFERENCE



Required to ship in Partially Assembled Format (additional shipping costs will apply)

All Bi-Folds are factory assembled before shipping. Where possible, the units are delivered partially assembled. In some cases, assembled delivery is not readily available and the units are disassembled before shipping. If you require the unit to be delivered partially assembled, please notate above.

CUSTOMER SIGNATURE TO PROCEED (Unsigned orders cannot be accepted)

SIGNATURE _____ DATE _____

SPIFF INFORMATION



Check to opt out

If your order qualifies for our SPIFF program, information MUST be filled out and sent in when order is placed in order to redeem. DSA cannot process SPIFFs sent separately from the order. Revised SPIFFs cannot be accepted, no exceptions. You are responsible for reporting SPIFF income for tax purposes. To enroll in and learn more about our SPIFF program, fill out and return our SPIFF Enrollment Form at www.DSADoors.com/SPIFF.

RECIPIENT NAME: _____

RECIPIENT EMAIL: _____

SPIFF AMOUNT

\$.00

SIGNATURE

DATE

BUILDER REBATE INFORMATION

DSA provides a Rebate of \$25.00 per Pre-Hung Door Unit to our Preferred Builders. To qualify for Rebates, Builder must be approved in our Preferred Builder Program, and purchases must be specified by the Purchasing Dealers at the time of order. Builder Applications and Claim forms must be sent with completed W9 and ACH instructions to DSAAP@DSADoors.com.

BUILDER NAME: _____

BUILDER EMAIL: _____

DEVELOPMENT NAME: _____

LOT / UNIT #: _____

REBATE AMOUNT

\$.00

SIGNATURE

DATE

PO#:

JOB NAME:

COMPANY NAME:

DATE:

SHIPPING ADDRESS:

CONTACT NAME:

CITY:

STATE:

ZIP:

PHONE #:

UNIT SPECIFICATIONS

CONFIGURATION: ☐ P-48" ☐ P-60" ☐ P-64" ☐ P-72"

SIDELITES & TRANSOM: 12" Direct Set

☐ P+1SL ☐ P+2SL ☐ P+T ☐ P+T+1SL ☐ P+T+2SL

DOOR HEIGHT: ☐ 8'0" ☐ 9'0"

WOOD SPECIES: Mahogany Stain Grade 3"

DOOR STYLE: _____

GLASS OPTION: _____

DIRECT SET SIDELITE/TRANSOM GLASS:

☐ Clear IG Low E ☐ Sandblasted IG Low E ☐ N/A

BRICKMOULD: ☐ S4S (3-1/2") ☐ 180 (2")

☐ Applied ☐ Unapplied ☐ No Brickmould

OTHER: _____

THRESHOLD OPTIONS:

- ☐ ADA Saddle Sill
☐ Oil Rubbed Bronze
☐ Brushed Nickel
☐ Flat Foot Jamb

JAMB SIZE: ☐ 5-7/8" ☐ 6-9/16"

OTHER: _____

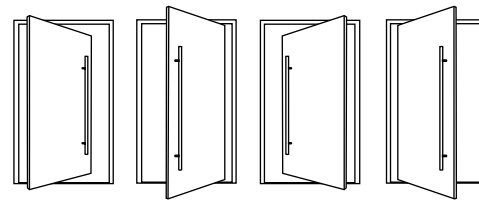
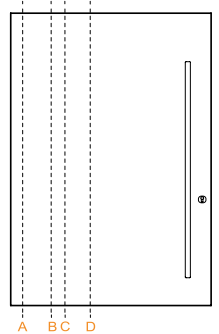

☐ LHIS ☐ LHOS ☐ RHIS ☐ RHOS

PIVOT OFFSET:

- ☐ A: 4"
☐ B: 12"
☐ C: 16"
☐ D: 24"

HARDWARE & FINISHING OPTIONS

CONTEMPORARY HARDWARE

- ☐ HOPPE CONTEMPORARY MULTIPOINT LOCK
☐ SQUARE ROSETTE ☐ ROUND ROSETTE
☐ GU 3-POINT LOCK WITH EUROPEAN PROFILE CYLINDER
☐ SQUARE ROSETTE ☐ ROUND ROSETTE

MODERN PULL BARS

- ☐ 32" ROUND PULL BARS ☐ SATIN NICKEL
☐ 48" ROUND PULL BARS ☐ BLACK
☐ 71" ROUND PULL BARS
☐ 71" SQUARE OFFSET PULL BARS

SMART LOCK FOR MULTIPOINT

- ☐ GU 3-POINT LOCK WITH THUMBLATCH & DANALOCK V3
☐ KNOB INTERIOR HANDLE ☐ LEVER INTERIOR HANDLE
☐ GU 3-POINT LOCK WITH BELCANTO LEVER & DANALOCK V3

SMART KEYPAD ADD-ON:

- ☐ INCLUDE DANAPAD V3
☐ NO DANAPAD V3

FINISH:

- ☐ SATIN NICKEL
☐ BLACK

PREFINISHING:

- ☐ Unfinished ☐ Russet
☐ Chestnut ☐ Coco ☐ Cinnamon Bark

SPECIAL INSTRUCTIONS OR ADDITIONAL INFORMATION:

SPIFF INFORMATION

☐ Check to opt out

If your order qualifies for our SPIFF program, information MUST be filled out and sent in when order is placed in order to redeem. DSA cannot process SPIFFs sent separately from the order. Revised SPIFFs cannot be accepted, no exceptions. You are responsible for reporting SPIFF income for tax purposes. To enroll in and learn more about our SPIFF program, fill out and return our SPIFF Enrollment Form at www.DSADoors.com/SPIFF.

RECIPIENT NAME: _____

RECIPIENT EMAIL: _____

SPIFF AMOUNT

\$.00

SIGNATURE

DATE

BUILDER REBATE INFORMATION

DSA provides a Rebate of \$25.00 per Pre-Hung Door Unit to our Preferred Builders. To qualify for Rebates, Builder must be approved in our Preferred Builder Program, and purchases must be specified by the Purchasing Dealers at the time of order. Builder Applications and Claim forms must be sent with completed W9 and ACH instructions to DSAAP@DSADoors.com.

BUILDER NAME: _____

BUILDER EMAIL: _____

DEVELOPMENT NAME: _____

LOT / UNIT #: _____

REBATE AMOUNT

\$.00

SIGNATURE

DATE

CUSTOM PIVOT DOOR QUOTE REQUEST FORM

10681 World Trade Blvd Raleigh, NC 27617 • (919) 781-3200
Custom@DSADoors.com • www.DSADoors.com

PO#:

JOB NAME:

COMPANY NAME:

DATE:

SHIPPING ADDRESS:

CONTACT NAME:

CITY:

STATE:

ZIP:

PHONE #:

UNIT SPECIFICATIONS

CONFIGURATION: **P -**

DOOR THICKNESS: 3"

☐ P+1SL

slab width in inches

DOOR HEIGHT:

☐ P+2SL

☐ P+T

☐ 8/0 ☐ 10/0

☐ P+T+1SL

☐ P+T+2SL

☐ 9/0

OTHER

TIMBER: ☐ Mahogany ☐ Knotty Alder ☐ Accoya®

☐ White Oak ☐ Walnut

DOOR STYLE:

GLASS OPTION:

SIDELITE:

TRANSOM:

BRICKMOLD:

THRESHOLD OPTIONS:

☐ ADA Saddle Sill

☐ Oil Rubbed Bronze

☐ Brushed Nickel

☐ Flat Foot Jamb

JAMB SIZE: ☐ 5-7/8" ☐ 6-9/16"

OTHER:

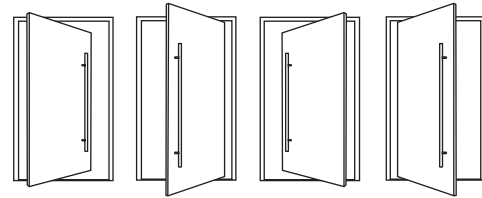
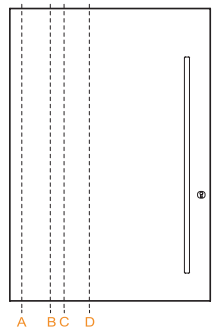

☐ LHS

☐ LHOS

☐ RHIS

☐ RHOS

PIVOT OFFSET:

☐ A: 4"

☐ B: 12"

☐ C: 16"

☐ D:

HARDWARE & FINISHING OPTIONS

CONTEMPORARY HARDWARE

☐ HOPPE CONTEMPORARY MULTIPOINT LOCK

☐ SQUARE ROSETTE

☐ ROUND ROSETTE

☐ GU 3-POINT LOCK WITH EUROPEAN PROFILE CYLINDER

☐ SQUARE ROSETTE

☐ ROUND ROSETTE

MODERN PULL BARS

FINISH:

☐ 32" ROUND PULL BARS

☐ SATIN NICKEL

☐ 48" ROUND PULL BARS

☐ BLACK

☐ 71" ROUND PULL BARS

☐ 71" SQUARE OFFSET PULL BARS

SMART LOCK FOR MULTIPOINT

☐ GU 3-POINT LOCK WITH THUMBLATCH & DANALOCK V3

☐ KNOB INTERIOR HANDLE

☐ LEVER INTERIOR HANDLE

☐ GU 3-POINT LOCK WITH BELCANTO LEVER & DANALOCK V3

SMART KEYPAD ADD-ON:

☐ INCLUDE DANAPAD V3

☐ NO DANAPAD V3

FINISH:

☐ SATIN NICKEL

☐ BLACK

PREFINISHING:

☐ Unfinished

☐ Russet

☐ Ebony (Accoya®)

☐ Chestnut

☐ Coco

☐ Cinnamon Bark

SPECIAL INSTRUCTIONS OR ADDITIONAL INFORMATION:

SPIFF INFORMATION

☐ Check to opt out

If your order qualifies for our SPIFF program, information MUST be filled out and sent in when order is placed in order to redeem. DSA cannot process SPIFFs sent separately from the order. Revised SPIFFs cannot be accepted, no exceptions. You are responsible for reporting SPIFF income for tax purposes. To enroll in and learn more about our SPIFF program, fill out and return our SPIFF Enrollment Form at www.DSADoors.com/SPIFF.

RECIPIENT NAME:

RECIPIENT EMAIL:

SPIFF AMOUNT

\$.00

SIGNATURE

DATE

BUILDER REBATE INFORMATION

DSA provides a Rebate of \$25.00 per Pre-Hung Door Unit to our Preferred Builders. To qualify for Rebates, Builder must be approved in our Preferred Builder Program, and purchases must be specified by the Purchasing Dealers at the time of order. Builder Applications and Claim forms must be sent with completed W9 and ACH instructions to DSAAP@DSADoors.com.

BUILDER NAME:

BUILDER EMAIL:

DEVELOPMENT NAME:

LOT / UNIT #:

REBATE AMOUNT

\$.00

SIGNATURE

DATE